

## Screening for early diagnosis and prevention of tumors of the colon-rectum

### OCCULT BLOOD IN FECES

#### Instructions for collecting the sample

The kit includes a small flask (tube) and a plastic envelope

- 1- Collect a sample of feces in a clean dry container (eg. one of plastic or aluminium)
- 2- Unscrew the green top and remove the stick, taking care not to spill the liquid in the tube. It is a preservative for the sample
- 3- Scrape just the tip of the stick over the feces in 3 or 4 different points
- 4- Collect only the feces that are left on the tip of the stick. Excessive amounts of feces are of no use and make the sample collected impossible to use for performing the test
- 5- Insert the stick into the tube, push the top down until it clicks and shake it. The liquid must remain almost transparent and very fluid
- 6- Place the flask in the plastic envelope supplied and keep it in a refrigerator until it is returned, which must be done as soon as possible and at the latest within 2 days

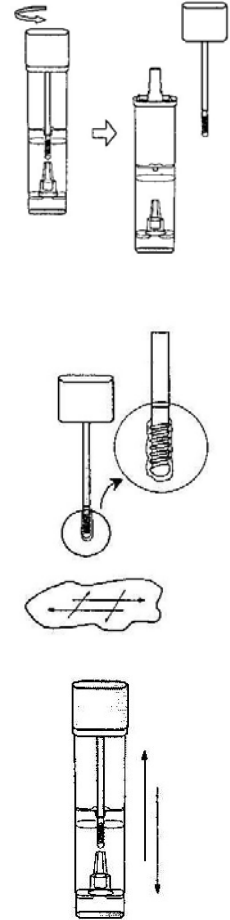

**ENTRO AL MASSIMO DUE GIORNI DALLA RACCOLTA, IL CAMPIONE ANDRA' POSTO ALL'INTERNO DEL CONTENITORE REFRIGERATO SITO PRESSO**

---



---



---

**AT THE LATEST WITHIN TWO DAYS AFTER COLLECTION, THE SAMPLE SHOULD BE PLACED INSIDE THE REFRIGERATED CONTAINER LOCATED AT**

---



---



---

#### **NB**

- 1- It is not necessary to follow any special diet before collecting the feces
- 2- Do not perform the test during your period or when hemorrhoidal bleeding occurs
- 3- Avoid contaminating the feces with urine
- 4- Take care not to soil the outside of the flask and the bar code label
- 5- Do not clean the tube and the label with alcohol
- 6- Do not damage the aluminium foil on the base of the tube

**The tube is for diagnostic use: do not swallow the liquid and keep out of reach of children**

**USE THE TUBE WITHIN 6 MONTHS OF THE DELIVERY DATE, OTHERWISE COLLECT A NEW ONE BY CALLING THE SCREENING CENTRE**